

...and lushly landscaped provide the Pelican Bay's first single... Pelican Bay... offering purchasers... array of choice... along the golf... prestigious atmosphere... Residents... walking... cycle paths

...ity... are enforced... with construction... concept, architectural... house Communities... to initial construction.

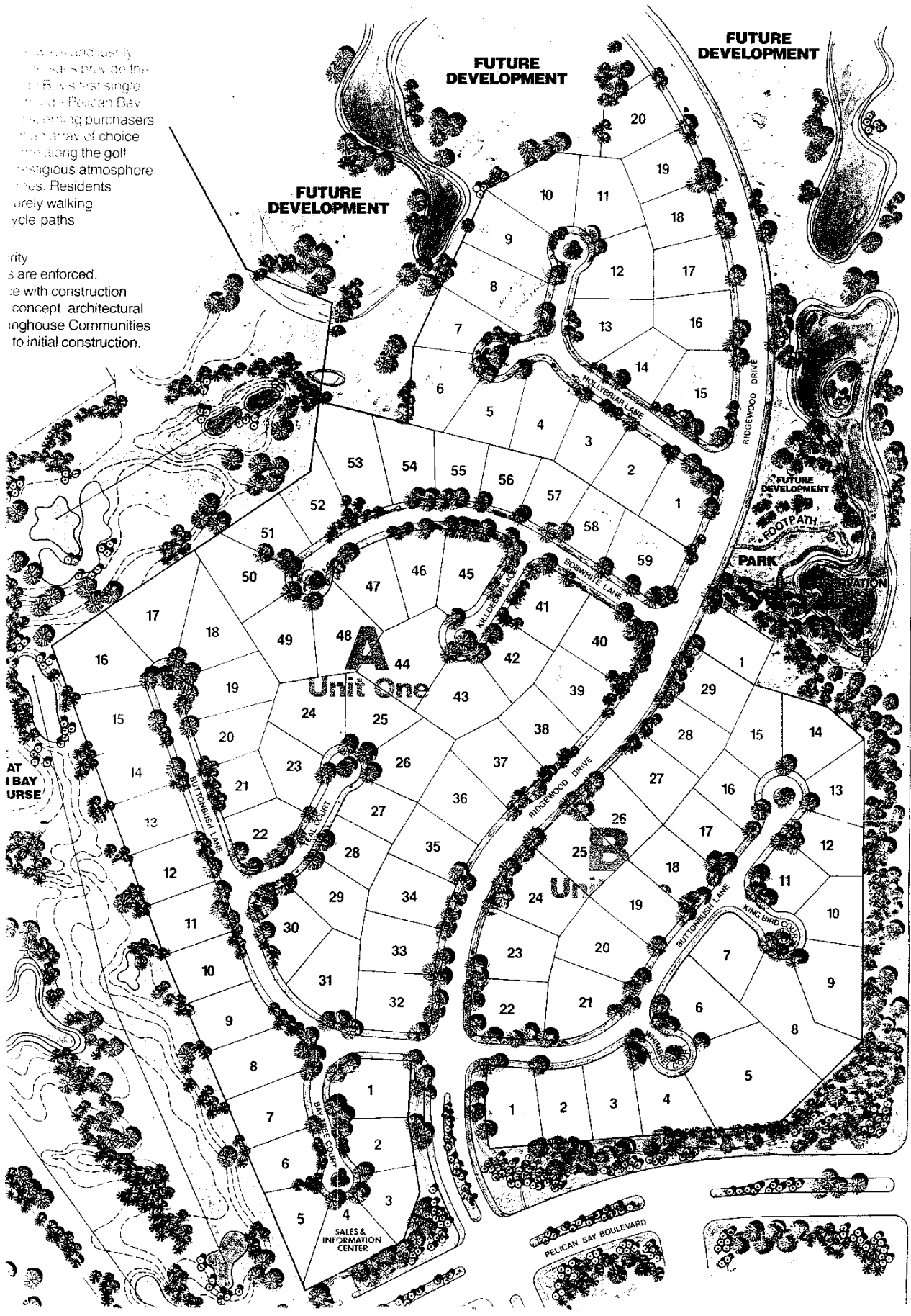

U.S. 41 TAMPA TRAIL

PELICAN BAY UNIT 4

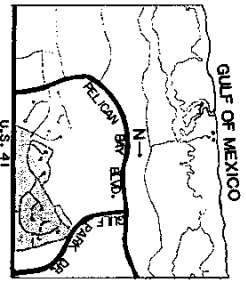

- NOTE:
1. This drawing is an artist's conception of a complete family residential site. The subdivision map of any lot includes features and structures which are not shown.
 2. All lots shown on this drawing are subject to deed restrictions. These restrictions are recorded in the public records of the State of Florida and are available for all buildings and structures built on approved lots prior to construction or alteration.
 3. All streets, R.O.W. are 60' (thru) feet wide unless otherwise noted. Lot dimensions, site and shape are shown. The location and extent of easements and other features are shown. The location and extent of easements are shown. The location and extent of easements are shown.
 4. This drawing should not solely be relied upon in any transaction of the project's development. A physical survey should be obtained from a licensed surveyor.
 5. This drawing has been prepared based on data available at the time of printing for the purpose of illustrating the general layout of the project. The subdivision map of any lot includes features and structures which are not shown.
 6. For specific sales information, contact Pelican Bay Properties, Inc. or a licensed real estate broker.
 7. Not drawn to scale.

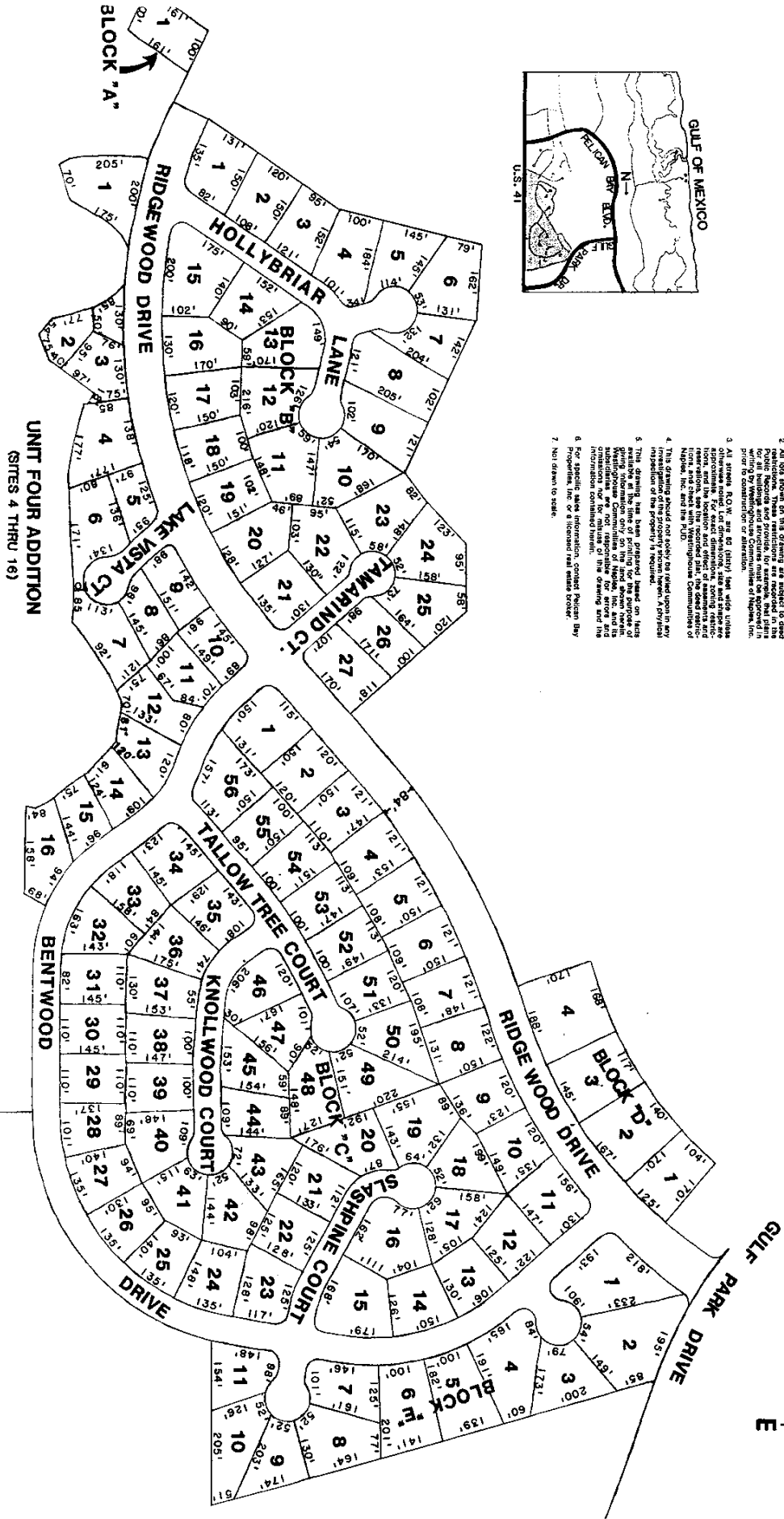

1"=200'
(3/86)